

The Australian and New Zealand Society  
of Occupational Medicine Inc. (ANZSOM)



**HERE  
& NOW**

Contemporary issues in occupational  
medicine and workplace health

# ANNUAL SCIENTIFIC MEETING 2015

Sofitel Brisbane Sunday 23rd August to Wednesday 26th August 2015

MAJOR SPONSOR



» **PROGRAM 2015**

## » sponsors & supporters



ANZSOM gratefully acknowledges SonicHealth Plus as the major sponsor for the 2015 ASM.



We also gratefully acknowledge *beyondblue* as the Conference Dinner sponsor.



The Dust Diseases Board NSW is acknowledged as a long time supporter of ANZSOM and sponsor of the ASM.



Austroads is acknowledged for supporting the session on Fitness to Drive.

Slater and Gordon is acknowledged for supporting the Mock Court session.

### EXHIBITORS & ADVERTISERS



Please see details of all our sponsors and exhibitors later in the program.

## » welcome

On behalf of the Queensland Branch of ANZSOM I extend a warm welcome to the 2015 Annual Scientific Meeting, and of course to our beautiful city of Brisbane, the gateway to this wide and varied state.

Our conference theme “Here and Now” reflects a rapidly changing work environment, which has brought new challenges and changing expectations for industry and for those working in occupational health. The program is far reaching, engaging and interactive, and draws on the expertise and experience of leaders in fields such as mental health, workplace violence, travel medicine, occupational exposures, transport and much more. A particular highlight is the mock court session on the final day which will see some of our experienced members pitching their expert witness skills. I’m also very pleased to say that we have a record number of contributed papers, so please support these presenters.

The diverse and engaging program results from the concerted efforts of many, including the speakers, the organising committee and members more broadly. I am sincerely grateful for these efforts, which are vital to ensuring this major event of the Society is successful. My particular thanks to the organising committee, Keith Adam, Sandra Code, Chris Cunneen, Vern Madden, Melinda Miller, Peter Ruscoe and Amanda Sillcock, who have worked tirelessly these past twelve months with the support of the Federal Executive and the Secretariat. Also particular thanks to session organisers John Gall and Bruce Hocking who have lent their extensive education experience to develop the mock court and fitness to drive sessions respectively.

My thanks also to our supporting sponsors whose involvement adds considerably to the educational content and enables us to deliver a high quality event to you. Please support these organisations by visiting their booths and using their services.

All that is left to say is thank you for attending and trust you have a rewarding and enjoyable experience travelling with us over the next three days, and enjoy renewing some old friendships and forging some new ones in the process.

**Dr Edward Foley**

*Chair, Queensland Branch*

### Need help?

Contact the Conference Secretariat on +61 438 577 528 or +61 408 530 865

Make sure you download the ASM App for updates throughout the conference.

### Registration/Hospitality desk hours:

- » Sunday 23 August: 5.30pm - 9.00pm
- » Monday 24 August: 8.00am - 5.00pm
- » Tuesday 25 August: 8.00am - 6.00pm
- » Wednesday 26 August: 8.30am - 4.00pm

Cuvee Lounge – Lobby Level  
Ann Street Lobby – Level 2  
Ann Street Lobby – Level 2  
Ann Street Lobby – Level 2

## » venue map

### THE SOFTEL HOTEL (MAIN VENUE) 249 TURBOT ST, BRISBANE

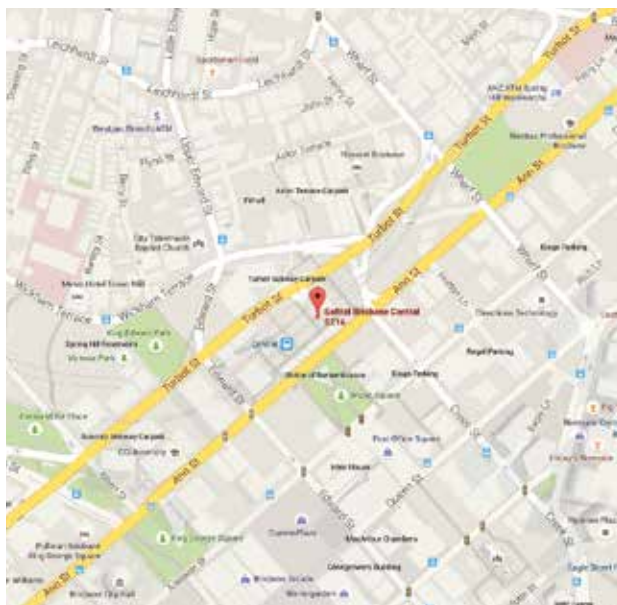

Parking available at the Sofitel Hotel or Wilson's carpark (160 Ann St, Brisbane)

### TATTERSALL'S CLUB (CONFERENCE DINNER) 215 QUEEN ST, BRISBANE



Parking available at Queens Plaza (226 Queen St, Brisbane)

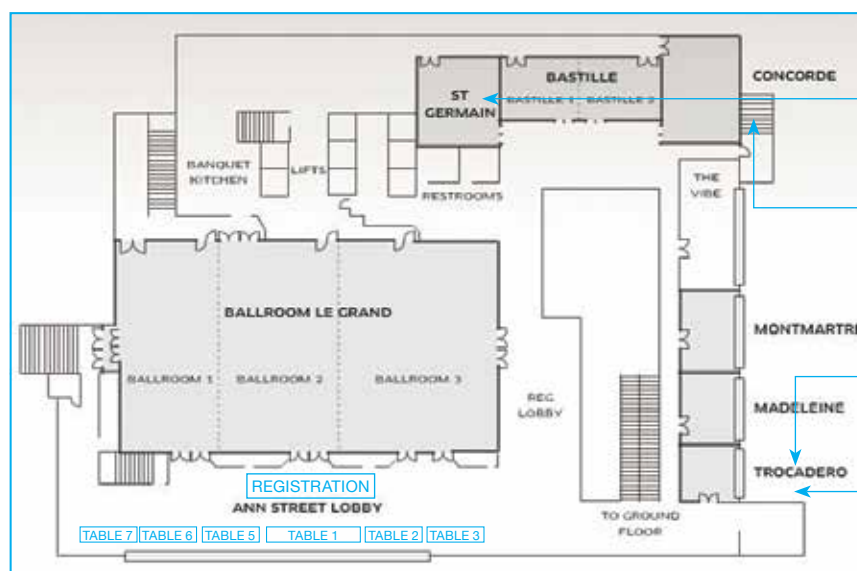

**Conducting Pre-employment Examinations**  
Monday 24th August  
1.15pm - 4.15pm

**CPR Workshops**  
Monday 24th August  
1.15pm - 3.45pm  
4.15pm - 6.45pm

**General Council Meeting**  
Sunday 23rd August  
3.30pm - 5.30pm

**Nursing Stream**  
Tuesday 25th August  
2.15pm - 3.15pm

### EXHIBITORS:

1. Sonic HealthPlus
2. miga
3. eReports
4. Amare Safety
5. QML Pathology
6. mlcoa
7. bioCSL



# Cohort

The Occupational Health Software

Cohort is a market-leading occupational health software system, now available and supported in Australasia. Having evolved over 20 years, supported by a large and active user group, and used in the NHS, Occupational Medicine practices, and many large companies, Cohort is a robust and cost-effective investment for any Occupational Health service. Being fully customisable, it can fit with the way you run your service, providing your clients with the very latest in Occupational Health technology.

**With Cohort you can:**

- Run a paper-free office
- Maintain a full electronic occupational health database, including digital documents and images
- Create your own electronic forms
- Offer online services such as pre-employment medicals, health surveillance questionnaires, and management referrals
- Analyse and report on all data collected

To help you understand how Cohort can meet your Occupational Health service needs, visit our website:  
[www.cohortsoftware.com.au](http://www.cohortsoftware.com.au)

Australasian and Asia-Pacific enquiries: [cohort@australismedical.com](mailto:cohort@australismedical.com)  
Medgate UK Ltd: [cohort.medgatesoftware.co.uk](http://cohort.medgatesoftware.co.uk)



## Always here for you.

*"Since 1899 generations of doctors have trusted us to support and protect them throughout their careers. Place your insurance in the hands of the experts. We are here for you."*

**Dr John O'Loughlin**  
Chairman



**miga**  
ALWAYS

Always the first choice for your medical indemnity insurance and protection.

To find out why, visit our website or call us on **1800 777 156**

[miga@miga.com.au](mailto:miga@miga.com.au)  
[www.miga.com.au](http://www.miga.com.au)

Insurance policies available through MIGA are underwritten by Medical Insurance Australia Pty Ltd (AFSL 255906). Membership services are provided by Medical Defence Association of South Australia Ltd. Before you make any decisions about any of our policies, please read our Product Disclosure Statement and Policy Wording and consider if it is appropriate for you. Call MIGA for a copy or visit our website. ©MIGA April 2015



## » social program



### WELCOME RECEPTION

Sofitel Hotel Brisbane, Cuvée Lounge  
Sunday 23rd August from 6.30pm

Join us for canapés and beverages in the elegant Cuvée Lounge Bar located on the ground floor of the hotel. The reception is included in the cost of full registration. Additional tickets can be purchased separately at the registration desk, which will be located outside the Cuvée Lounge from 5.30pm.

### CONFERENCE DINNER

Tattersall's Club, Grand Ballroom | Tuesday 25th August from 7.00pm | 215 Queen St, Brisbane

Experience the ultimate in atmosphere, style and service at the Tattersall's Club Grand Ballroom, located just minutes from the Sofitel Hotel. Included with full registration is a three course menu and beverages, with pre-dinner drinks served from 7pm. The conference dinner is included in the cost of full registration. Additional tickets can be purchased separately from the registration desk.



### INTRODUCING SPECIAL GUEST LI CUNXIN

Guest speaker at the ANZSOM Conference Dinner

We are very pleased to announce a very special guest speaker at this year's ASM. Li Cunxin (pronounced "Lee Schwin Sing") is a remarkable man borne of a remarkable story. He published a runaway best-selling book about his extraordinary life, *Mao's Last Dancer*, in which he recounts his journey to becoming one of the best dancers in the world, including principal dancer with the Australian Ballet.

Also presenting will be **Georgie Harman**, CEO *beyondblue* who will provide valuable insights into the organisation's workplace initiatives in promoting mental health.

### GETTING THERE:

The Tattersalls Club is a 7 min walk (550 metres) from the Sofitel Hotel Brisbane:

- » Walk west towards Turbot St - 24 metres
- » Turn left onto Turbot St - 160 metres.
- » Turn left onto Edward St - 350 metres.
- » Turn right onto Queen St - Destination will be on the left - 34 metres.

The conference dinner is proudly sponsored by



# POOR MENTAL HEALTH IS LIKELY TO AFFECT 1 IN 5 WORKERS.

Depression and anxiety are the often hidden factors that impact many workers, costing Australian business about \$10.9 billion a year. So, addressing mental health in the workplace is not only good for people, it's better for the bottom line, too. Designed for employers, employees and professionals working in occupational medicine and workplace health, the Heads Up website will give you the information, resources and tools to improve mental health in the workplace.

**Go to [headsup.org.au](https://headsup.org.au)**

ABS 2008 'National Survey of Mental Health and Wellbeing' PwC 2014, 'A mentally healthy workplace: Return on Investment Analysis'

## Heads up

THE MENTALLY  
HEALTHY  
WORK  
PLACE ALLIANCE





## » site visits

MONDAY 24<sup>TH</sup> AUGUST

This year's program features a diverse range of site visits, designed to provide an insight into industries and workplaces in the region. Visits have been pre-booked with your registration. Buses will leave from the Sofitel front driveway. The time of return will vary for each site visit, depending on the starting time and distance to be travelled. If you have forgotten which site you registered for, please contact the registration desk, as seats are strictly reserved due to limited numbers. Contact details for each visit leader and clothing requirements are noted below.

### Century Yuasa Batteries, 1.15pm



Century Yuasa Batteries is the largest manufacturer in Australia of lead acid batteries for automotive and industrial purposes. The visit to their Carol Park premises will be hosted by Dr Graeme Edwards, occupational and environmental physician and National Medical Advisor to the Century Yuasa Group of companies. The visit will provide an opportunity to observe the traditional grid casting technology and the strip mill / plate expander technologies, and to discuss the health monitoring and lead-risk management strategies used to minimise hazardous exposure.

**Site visit contact: Dr Graeme Edwards, +61 411 747 445**

Clothing/safety requirements:

- » Please wear smart casual attire appropriate for the weather conditions.
- » Fully enclosed appropriate footwear must be worn.
- » High visibility vests, vision and hearing protection will be provided.
- » No food or drinks will be provided during the tour; please bring a bottle of water.

### Brisbane Botanic Gardens, Mt Coot-tha, 1.15pm

The Brisbane Botanic Gardens are recognised as Australia's premier subtropical botanic gardens, spanning 56 hectares and featuring up to 20,000 native and exotic plants from around the world. This rare 'behind the scenes' experience will be led by the garden curator Dale Arvidsson, and will provide an opportunity to discuss a range of workplace hazards directly with the gardeners. There are no special clothing/safety requirements.

**Site visit contact: Edward Foley, +61 417 704 211**



### Qube Logistics (formerly P&O), 1.00pm

Qube Logistics is Australia's largest provider of integrated port logistics and wharf cartage services. Their national network and infrastructure are driven by cutting-edge technology and co-located services in all Australian capital ports. The visit to their Port Freight Terminal will encompass the following:

- » Port logistics services
- » Transport
- » Intermodal terminal
- » Warehousing and distribution
- » Container parks
- » Container freight station
- » Supply chain management
- » Special projects

**Site visit contact: Chris Cunneen, +61 404 668 111**

Clothing/safety requirements:

- » Long pants and fully enclosed appropriate footwear must be worn.
- » High visibility vests, hard hats, vision and hearing protection will be provided.
- » No food or drinks will be provided during the tour; please bring a bottle of water.



### The Smith's Snackfood Company, 12.30pm

The Smith's Snackfood Company is the snackfood operating division of PepsiCo Australia & New Zealand. It encompasses well known brands such as Doritos, Sakata, Nobby's Nuts and Burger rings. The Tingalpa factory visit will provide insight into snack food production within urban location, the occupational exposures, the workforce issues and the various protocols/controls utilised to reduce onsite risk.

**Site visit contact: Chris Cunneen, +61 404 668 111**

Clothing/safety requirements:

- » Long pants and fully enclosed appropriate footwear must be worn.
- » High visibility vests, hair nets, vision and hearing protection will be provided.
- » No food or drinks will be provided during the tour; please bring a bottle of water.







» **sunday, aug 23<sup>rd</sup> 2015**

## QML Pathology Commercial Solutions



- ✓ Over 500 Collection Centres and extensive courier network statewide
- ✓ 24-48 hour turnaround



### As part of our service we offer:

- ✓ Drug and Alcohol Testing
- ✓ Environmental Testing
- ✓ Testing for exposure to Toxic Chemicals/Metals
- ✓ Vaccines
- ✓ Pre-employment Health Checks.



**NATA** QML Pathology laboratories are all NATA-accredited\* facilities



**3.30pm – 5.30pm**

**ANZSOM General Council Meeting**  
*Sofitel Hotel,  
Trocadero Room, Level 2*

**5.30pm – 9.00pm**

**Registration**  
*Sofitel Hotel,  
Cuvée Lounge, Lobby Level*

**6.30pm – 9.00pm**

**Welcome Reception (included in full registration)**  
*Sofitel Hotel,  
Cuvée Lounge, Lobby Level*

### Hugh Denehy Oration – Dr Keith Adam

ANZSOM is pleased to welcome long-standing ANZSOM member Dr Keith Adam to give the 2015 Hugh Denehy Oration, in honour of one of ANZSOM's founding fathers Dr Hugh Denehy (1925-1996).

Hugh was a great contributor to the profession of occupational medicine and held the position of Chairman of the VIC/TAS Branch before becoming Federal President. He then became a Foundation Fellow of the Australian College of Occupational Medicine in 1982. Such contributions are highly valued by the Society and we seek to reflect them in our selection for this annual presentation in his honor. Dr Keith Adam has therefore been a logical choice.

As a specialist occupational physician Keith has been actively involved in all aspects of occupational and environmental medicine for more than three decades and has provided advice to over 500 companies. He has also been an active contributor to Branch activities and currently sits on the Federal Executive. Keith is a keen educator and mentor, inspiring several generations of occupational and environmental physicians, as well as medical and engineering students.

We look forward to sharing Keith's insights at the 2015 Hugh Denehy Oration, Tuesday 25th at 1.30pm.

### Registration/Hospitality desk hours:

- |  |                            |
|--|----------------------------|
| » Sunday 23 August: 5.30pm - 9.00pm    | Cuvée Lounge – Lobby Level |
| » Monday 24 August: 8.00am - 5.00pm    | Ann Street Lobby – Level 2 |
| » Tuesday 25 August: 8.00am - 6.00pm   | Ann Street Lobby – Level 2 |
| » Wednesday 26 August: 8.30am - 4.00pm | Ann Street Lobby – Level 2 |

**qml.com.au/commercial.aspx**  
P: (07) 3121 4945

\*QML Pathology is accredited to provide onsite and laboratory confirmations in accordance to AS:4308 AND AS:4760

**QML Pathology**

*Specialists in Private Pathology since the 1920s*

## » monday. aug 24<sup>th</sup> 2015

8.00am - 5.00pm

### REGISTRATION

*Sofitel Hotel, Cuvee Lounge, Ann Street Lobby Level*

9.00am

### Welcome Address

*Councillor Angela Owen-Taylor, Councillor for Parkinson*

9.15am

### SESSION THEME: Psychological issues in the workplace

*Chair: Dr Edward Foley*

An understanding of psychological issues in the workplace is essential for all occupational health professionals, so our first session will be universally relevant. Our expert presenters will address growing problems such as PTSD and workplace violence, as well as ongoing challenges such as drugs and alcohol and critical incidents. The domains of recognition, prevention, early treatment and return to work will provide a common thread, with ample opportunity to explore the issues through panel discussion.

#### Turning back the rising tide of PTSD

**Dr Peter Cotton, Psychologist, Health Services Australia and Insight SRC**

Some workplaces are experiencing a growth in claims relating to post traumatic stress disorder (PTSD). What organisational factors contribute to PTSD and how can these be addressed? What are the latest innovations for treatment, particularly for work focused treatment?

10.00am

### Violence in the workplace

**Dean Chandler, Director, Allsafe**

Violence too is an increasing workplace issue. What is meant by violence? What factors contribute to violence and what effects can it have in the workplace? What workplace policies should be in place to manage violence? What procedures and training are required for employees to enable them to manage violence in the workplace?

10.30am

### Morning tea

11.00am

### Substance misuse - determining fitness for work

**Dr Greg Apel, Psychiatrist, Brisbane Private Hospital**

Substance misuse in the workplace presents an ongoing challenge. What factors need to be considered when determining a person's fitness to return to work? Do different substances require different approaches? What are the considerations for safety critical work?

11.30am

### If not critical incident debriefing then what?

**Dr Arlene Walker, Psychologist, Associate Head of School (Rural and Regional Development), Deakin University**

Formal critical incident debriefing is dead and buried but organisations continue to expect a formal process. What alternative models are available to manage critical incidents and the potential impacts in the workplace? How can we as health professionals advocate for best practice approaches?

12.00pm

### Panel discussion

12.30pm

### Lunch

1.15pm – 4.30pm

### SITE VISITS

Site visits are a highlight of the ANZSOM conference and are an opportunity to see first-hand the occupational health issues of local industries. Places on the site visits are pre-allocated. For details see page 8 of the program.

- » *Century Yuasa Batteries*
- » *Brisbane Botanic Gardens, Mt Coot-tha*
- » *Qube Logistics*
- » *The Smith's Snackfood Company*

1.15pm

### PARALLEL WORKSHOPS (all pre-allocated)

#### CPR update - Session 1

*Concorde Room*

**Ian Cash, Australasian SOS Oxygen**

A practical cardiopulmonary resuscitation update, including use of automated external defibrillation.

#### Violence in the workplace

*Ballroom*

**Dean Chandler, Allsafe**

An opportunity to explore in detail the current approaches to management of violence in the workplace, brought to life with scenarios and role plays.

#### Conducting pre-employment examinations

*St Germain Room*

**Dr Vern Madden, The Health Advantage; Dr Amanda Sillcock, Occupational Physician**

A practical session aimed at updating skills for pre-employment examinations. Particularly valuable for nurses but relevant to all.

2.45pm

### Afternoon tea

3.00pm

### PARALLEL WORKSHOPS (continued)

#### CPR update - Session 1 (3.45 finish)

#### Violence in the workplace (4.30pm finish)

#### Conducting pre-employment examinations (4.30pm finish)

4.15pm

#### CPR update - Session 2

**Ian Cash, Australasian SOS Oxygen (6.45 finish)**





## » tuesday aug 25<sup>th</sup> 2015

8.00am - 5.00pm

### REGISTRATION

*Sofitel Hotel, Cuvee Lounge, Ann Street Lobby Level*

### SESSION THEME: Healthy and safe travel

*Chair: Dr Vern Madden*

8.30am

### Travel for work – preparing for safe & healthy travel overseas

Dr Deborah Mills, Medical Director, Dr Deb's Travel Medicine Clinics

9.30am

### Preventing and managing overseas emergencies

Colin MacDonald, Director Corporate Services, Aspen Medical

10.15am

### Morning tea

10.45am

### SESSION THEME: Fitness to drive – the grey and the difficult

*Chair: Dr Bruce Hocking*

This interactive session will provide an opportunity to discuss a number of case studies in order to:

- » Increase understanding of problematic aspects of assessing fitness to drive with regard to commercial vehicle drivers, including:
  - Blackouts and single seizures
  - Blackouts and arrhythmias
  - Sleep apnoea
  - Diabetes
- » Improve interaction between occupational physicians and relevant specialists regarding “fitness for duty” examinations for commercial vehicle drivers .e.g., by occupational physicians providing useful referral information and relevant specialists providing information to aid decision-making regarding employment status.
- » Improve understanding of the role of, and communications with, the Driver Licensing Authority regarding licence status.

The discussion will be supported by four experts.

- » Dr Noel Saines , Neurologist, Wesley Medical Centre
- » Dr Rob Perel, Cardiologist, Mater Private Hospital Brisbane
- » Dr. Chris Zappala, Thoracic and Respiratory Physician, The Wesley Hospital
- » Dr Clair Sullivan, Deputy Chair of Medicine, Princess Alexandra Hospital

This session is proudly supported by Austroads



**Austroads**

12.45pm

### Lunch

1.30pm

### Hugh Denehy Oration

*Chair: Dr Amanda Sillcock*

Dr Keith Adam, National Lead Occupational Physician, Mining and Transport, Medibank Health Solutions

2.15pm - 3.15pm

### MEDICAL STREAM

*Chair: Dr Chris Cunneen  
Ballroom*

### Toxic environmental exposures in pregnancy

Assoc Prof Michael Gabbett, Clinical Geneticist, Griffith University

### Diesel particulate matter – carcinogenesis and other health effects

Prof Zoran Ritovski, Nanotechnology and Molecular Science, Queensland University of Technology

### NURSING STREAM

*Chair: Mrs Sandra Code  
Trocadero Room*

### Vaccination certification requirements for nurses

Rob Timmings, Rural and Remote in Nurse Educator, Director, ECT4Health

### Beyond the EAP. How to promote worker resilience and reduce workplace stress

Kristina Dalgleish, Director, Health@ Work Pty Ltd

3.15pm

### Afternoon tea

3.30pm



**Dust Diseases Board**

*Chair: Dr Maggie Goldie*

### Advances in the treatment of asbestos related disease

Assoc Prof Glen Reid, Senior Scientist, Asbestos Diseases Research Institute

This session is proudly supported by the Dust Diseases Board, NSW

4.00pm

### Australian Privacy Principals update, complying with the APP obligations

Mr Kegan Scherf, Workplace Relations Adviser, AMA Queensland

4.30 – 5.30pm

### ANZSOM Annual General Meeting

*Ballroom*

7.00pm



### Conference Dinner –

*Tattersalls Club, Grand Ballroom*

Guest speakers:

- » Georgie Harman, CEO *beyondblue*
- » Li Cunxin, Artistic Director of Queensland Ballet and author of Mao's Last Dancer

This session is proudly supported by *beyondblue*





*Independent Medical Examiners required Australia wide.*

## Occupational Physicians

Consider a new income stream as an Independent Medical Examiner with mlcoa, the leading national provider of independent medical advisory services for:

Motor Vehicle Accidents: Workers Compensation: Fitness for Duties: the Military: Personal injuries & illness: Public Liability: Income protection and Superannuation claims

Opportunities are available in all capital cities and regional areas for flexible part time consulting in your private rooms or mlcoa's modern, well equipped facilities.



### mlcoa offers:

- > Advice, training and peer support
- > Full administration support: file preparation, typing and storage
- > Fully optimised consulting days
- > Full payment monthly – guaranteed
- > No medical negligence
- > Minimal court requirements
- > Interstate and regional consulting if desired

If you are interested in hearing more about what an organisation with 25 years experience and expertise can offer you as an individual, contact us at your earliest convenience.

### Carol Busby

mlcoa - Consultant Resources Coordinator

T: 0435 830 548

E: busbyc@mlcoa.com.au

W www.mlcoa.com.au

*Specialists must hold or be eligible for AHPRA Medical Specialist Registration*

## anzsom E-LEARNING PORTAL

Bringing CPD to your office & home computer, laptop or tablet\*



All financial ANZSOM members have the benefit of free access to quality e-Learning experiences. The ANZSOM e-Learning Portal also allows users to monitor their completed online CPD activities, for easy reporting at audit time.

Make sure you take advantage of the portal and log in to see what's available. Modules include both intensive interactive opportunities and select presentations given at ANZSOM meetings. As modules are added regularly, remember to keep checking back to see what's available.

Modules are specifically relevant to individuals involved in occupational health



The system will record your completed ANZSOM online learning activities for easy reporting



Print certificates and/or your completed activity list for use in audits



Variety of free modules are available for your CPD needs, at a time/place that suits your schedule

### Want to do more?

ANZSOM currently has an exciting opportunity for volunteers to become involved in writing the technical content of new online learning modules. This work not only supports the important activity but also attracts CPD points in its own right. The work is well supported by the Secretariat in terms of facilitating writing groups and managing documentation. Email [secretariat@anzsom.org.au](mailto:secretariat@anzsom.org.au) or call on 1300 600 515 for more information and to register your interest.

## » wednesday aug 25<sup>th</sup> 2015

8.00am - 5.00pm

### REGISTRATION

*Sofitel Hotel, Cuvee Lounge, Ann Street Lobby Level*

9.00am

### Your day in court – a mock court experience

*Chair & facilitator: Associate Professor John Gall*

Judge Bill Kearns, Barristers: John Miles, Donna Callaghan

Many of us will be called upon to present as expert witnesses. This well-prepared mock court experience will aim to demonstrate and engage participants in:

- » Understanding the requirements for preparation to provide testimony in court.
- » How to present medical evidence in court.
- » Effective communication in a courtroom.
- » The need to be an impartial witness for the court and not for the complainant or defendant.
- » How to manage difficult situations in court.
- » The need to remain within your area of expertise.

Three cases will be argued and critiqued to optimise the learning experience.

This session is proudly supported by Slater + Gordon Lawyers



10.30am

### Morning tea

11.00am

### Your day in court – a mock court experience (continued)

*Chair & facilitator: Associate Professor John Gall*

12.00pm

### Lunch

### CONTRIBUTED PAPERS

*Chair: Ms Melinda Miller*

12.45pm

### Complaints to the Medical Board arising out of Independent Medical Examinations

Dr John Wilson, Jobfit Health Group

1.05pm

### Electrical hypersensitivity

Dr Bruce Hocking, Bruce Hocking and Associates

1.25pm

### Of mice and men: Assessing the safety of on-farm mouse bait production

Associate Professor Anthony Brown, School of Rural Health, University of Sydney

1.45pm

### Conducting clinic audits of an oil / gas industry health service in Papua New Guinea

Dr David Crocker, Consultant occupational physician  
Dr Flora Jethro, Medical Officer, Oil Search Limited

2.05pm

### Occupational injury risk among ambulance officers & paramedics compared with other health care workers in Victoria, Australia – analysis of workers' compensation claims from 2003 to 2012

Dr Minainyo Helen Roberts, Monash University

2.25pm

### Nanotechnology: Health effects and risk management

Dr Devan Kumarasamy, PETRONAS (Petroliam Nasional)

2.45pm

### Red eye. How an occupational health team member should handle it?

Dr Miguel Sergio Kabilio, OSH Group

3.05pm

### Afternoon tea

3.25pm

### Close

**Have you visited the new ANZSOM website?**

Features Include:

- » Online registration for most ANZSOM events
- » Online subscription renewal
- » Access to online learning
- » Comprehensive events calendar



## » invited speakers

### SPEAKER PROFILES (IN ALPHABETICAL ORDER)

ANZSOM welcomes all our speakers to the conference and thanks them for their generous participation.

#### Dr Greg Apel

*Psychiatrist, Brisbane Private Hospital*

Dr Greg Apel is a Brisbane-based psychiatrist, who has long maintained an interest in the psychology of workplace issues, and has been an active participant in ANZSOM activities for many years. A major focus of Dr. Apel's work is with alcohol and drug using patients, with a busy inpatient practice and outpatient management for follow up and containment of these issues within workplace and family structures. The balance of clinical care and medico-legal assessments of fitness to drive in the patient group helps to maintain a perspective on employer and employee agendas and capacities to adapt to clinical situations as they arise.

#### Mr Ian Cash

*Director, Australasian SOS Oxygen*

Ian Cash is Director and founder of Australasian SOS Oxygen and First Responder Training Pty Ltd, a recognised training provider for the Royal Australian College of General Practitioners, and a provider for the University of Melbourne School of Dental Science, the Royal Dental Hospital of Melbourne and a range of private health care and industrial / commercial workplaces in Victoria, South Australia and Queensland. Ian's ongoing clinical role in coronary care and intensive care nursing helps to ensure his training is highly relevant and practical.

#### Mr Dean Chandler

*Director, Allsafe*

Dean Chandler is the Director and primary trainer of 'Allsafe', an organisation he set up to help deal with the hazard of workplace violence. Drawing on his extensive experience in law enforcement, diplomatic and personal protection, strategic response and operational security, he works with a range of different organisations to build knowledge, confidence and capability to deal with violence, including issues ranging from low level verbal abuse through to armed robbery.

#### Dr Peter Cotton

*Psychologist, Health Services Australia & Insight SRC*

Dr Peter Cotton is a clinical and organisational psychologist specialising in occupational mental health and wellbeing. He has published a number of book chapters and peer reviewed research papers, and is a Fellow of the Australian Psychological Society. He is a mental health advisor with SuperFriend and the Comcare Centre for Excellence in Mental Health and Wellbeing at Work. He is also a member of beyondblue's Workplace Mental Health Expert Advisory Group. In addition to his consulting work, Peter maintains a private clinical practice.

#### Mr Li Cunxin

*(Conference dinner speaker) – Artistic Director, Queensland Ballet*

Li Cunxin is a remarkable man borne of a remarkable story. He published a runaway best-selling book about his extraordinary life, *Mao's Last Dancer*, in which he recounts his journey to becoming one of the best dancers in the world, including principal dancer with the Australian Ballet. Now, after a successful career as an investment adviser, Li has recently returned to follow his passion for dance, becoming the Artistic Director of Queensland Ballet.

#### Ms Kristina Dalglish

*Director, Health@Work Pty Ltd*

Kristina has over 29 years of experience in corporate health management, most recently as the Director of Health@Work, an organisation delivering she delivering innovative and measurable health programs, both nationally and internationally. She was a founding member of the workplace health industry body, Workplace Health Association Australia (WHAA) and offers an in-depth understanding of the industry, including the latest trends in corporate health programs.

#### Associate Professor Michael Gabbett

*Clinical Geneticist, Griffith University*

Michael Gabbett is a full time clinical geneticist with Genetic Health Queensland. He has a special interest in prenatal genetics and birth defects. Michael is an Associate Professor at Griffith University and a senior lecturer at The University of Queensland medical school.

#### Associate Professor John Gall

*Principal, Era Health*

Associate Professor Gall has practised clinical forensic medicine in combination with occupational medicine for more than twenty years, with principal interests in aviation, underwater, rail and maritime medicine, cancer clusters, independent medical assessments and toxicology. In addition to his private clinical consulting roles, he is involved in both education and research and is an Associate Professor in the Department of Paediatrics, The University of Melbourne. He is also active in a number of professional societies, being the current President of the World Police Medical Officers (currently being renamed as the International Association of Clinical Forensic Medicine), and Vice President of the Australasian Association of Forensic Physicians. He is a member of the International Editorial Board of the Journal of Legal and Forensic Medicine.

#### Ms Georgie Harman

*CEO, beyondblue*

Ms Harman was appointed as the CEO of *beyondblue* in May 2014. She has significant and broad-ranging policy and service delivery experience in the community, public and private sectors in Australia and the United Kingdom. Previously, she was the Deputy CEO of Australia's National Mental Health Commission and acted as CEO for several months. The Commission was established in 2012 to provide independent advice to the Prime Minister on the performance of the mental health system and recommend reform actions. From 2006-2012, Ms Harman worked at the Commonwealth Department of Health where she had national responsibility for Australian mental health, suicide prevention and substance misuse policy and programs, including those targeting Aboriginal and Torres Strait Islander people. She was one of the architects of the 2011 cross-portfolio National Mental Health Reform Budget package. At the same time, she was responsible for the early strategy and development of legislation to introduce plain packaging of tobacco products in Australia – a world first.

#### His Honour William (Bill) Kearns SC

*Judge, Dust Diseases Tribunal*

His Honour Judge W (Bill) P Kearns, SC was appointed to the Bench of the District Court of New South Wales and the Dust Diseases Tribunal of New South Wales in July 2006. Most of his judicial duties are dedicated to the specialist work of the Dust Diseases Tribunal (DDT), though he also sits in the District Court. Prior to his judicial appointment, Judge Kearns enjoyed a varied and busy career as a barrister. He was admitted to the New South Wales Bar in 1972, to the ACT Bar in 1993 and was appointed Senior Counsel in 1999. This work was complemented with specialist appointments, including as a mediator, member of the Legal Aid Review Committee, contributions assessor and Acting Judge in the Compensation Court and the DDT.

#### Mr Colin Macdonald

*Director Corporate Services, Aspen Medical*

Colin Macdonald is Aspen Medical's Director of Corporate Services responsible for risk, health, safety and environment, security, training, quality, travel and property functions. Colin came to Australia from the United Kingdom where he had begun his HSE career while serving in the British Army. He joined the National Safety Council of Australia where he was the ACT Regional Manager providing a wide range of HSE consulting, auditing and training services to defence, government and private industry. He then spent 11 years as the Corporate HSE Manager with the Commonwealth Scientific and Industrial Research Organisation (CSIRO). Colin has a Master's degree in Safety Management and has considerable expertise and experience in HSE management, risk management, disaster and business continuity management, safety and security for overseas operations and emergency management.

#### **Dr Vern Madden**

##### ***Medical Director, The Health Advantage***

Dr Vern Madden graduated from the University of Queensland St Lucia in 1979, and after working in the public hospital system, spent over a decade working as a country GP. Since 2000, his practice has been solely devoted to occupational health including providing injury management and pre-employment services. Reflecting Vern's interest in education, The Health Advantage is a registered training organisation. Vern has jointly developed and patented a pre-employment assessment process that uses an algorithmic analysis to determine fitness.

#### **Dr Deborah Mills**

##### ***Medical Director, Dr Deb's Travel Medicine Clinics***

Dr Deborah Mills is one of the pioneers of travel medicine in Australia, and has been looking after the health needs of overseas travellers since 1988. She is the founding practice principle of "Dr Deb - The Travel Doctor" which operates two specialised travel medicine clinics in Brisbane. She is one of the founding members of the Travel Medicine Alliance, a network of over 30 travel medicine clinics across Australia, and acts as the group's medical spokesperson in the media. She has published in peer reviewed journals and has a particular interest in rabies. She has also been widely published in the lay press, including radio, television and social media. Her book "Travelling Well - the 'must-have' guide to a safe and healthy journey", is now in its 19th edition, with over 200,000 copies in print. She also has a keen interest in information technology systems including apps, blog, twitter, facebook, Youtube videos, online travel medicine training.

#### **Dr Robert Perel**

##### ***Cardiologist, Mater Private Hospital Brisbane***

Dr Robert Perel is a cardiologist who specialises in heart rhythm disorders and cardiac electronic implanted devices. In addition to his physician and cardiology training, he has completed a two-year Fellowship in Cardiac Electrophysiology at the University of Toronto in Canada, and is recognised as a Certified Electrophysiology Specialist and Certified Cardiac Device Specialist by the International Board of Heart Rhythm Examiners (IBHRE), affiliated with the Heart Rhythm Society. Robert performs procedures such as: implantation of cardiac monitors for further investigation of syncope; pacemaker implantation; implantation of defibrillators to treat dangerous arrhythmias and reduce risk of sudden cardiac death; and electrophysiology studies and catheter ablations to identify and treat cardiac arrhythmias. He also works as a general cardiologist managing patients with coronary heart disease, cardiomyopathy and valvular heart disease.

#### **Associate Professor Glen Reid**

##### ***Senior Scientist, Asbestos Diseases Research Institute***

Associate Professor Glen Reid received his PhD from the University of Göttingen in Germany, and followed this with a postdoc studying multi drug resistance at the Netherlands Cancer Institute in Amsterdam. After working on RNAi therapeutics at the biotech company Genesis Research & Development in Auckland, New Zealand, he was appointed ADRI's Senior Research Scientist in April 2009, where he established the Institute's cell and molecular biology labs. His translational research focuses on the identification of new markers and molecular targets for malignant mesothelioma, with a particular focus on microRNAs.

#### **Professor Zoran Ristovski**

##### ***Nanotechnology and Molecular Science, Queensland University of Technology***

Professor Ristovski is an atmospheric scientist with almost 20 years' experience in the area of airborne particle pollution, working at the International Laboratory for Air Quality and Health, QUT. His main areas of interest are in the characterisation of vehicle emission related nanoparticles, their physical and chemical properties, transport in the atmosphere as well as their toxicity. He has conducted a number of projects in this area for the Australian government and private industry and has published extensively. He has also received a number of grants both from the Australian government and industry. Professor Ristovski was one of the key academics in establishing the Biofuels Engine Research Facility (BERF), a modern engine emission research facility established through a joint investment from QUT, industry and the Australian Research Council. He is currently involved in several projects looking at issues relating to the utilisation of biofuels.

invited speakers

#### **Dr Noel Saines**

##### ***Neurologist, Wesley Medical Centre***

Dr Noel Saines is a Consultant Neurologist with rooms at the Wesley Hospital Brisbane. Dr Saines has an MBBS from Melbourne University and gained his FRACP in 1979. He is a member of the Australian and New Zealand Association of Neurologists the American Academy of Neurologists, the American Board of Electrodiagnostic Medicine and Fellow of the Australian Institute of Company Directors. Dr Saines has had a number of appointments including Assistant Professor of Neurology at Neurological Institute of Columbia University New York 1982-1983. Consultant Neurologist at Princess Alexandra Hospital and QE11 Hospital 1982-1986, Toowoomba Base 1992-1997, Mater Hospital Brisbane 1984-2002. He has been Chairman of the Medical Advisory Committee Wesley Hospital 2004-2006 and is current Deputy Chairman Q Comp Specialist (Neurology) Medical Assessment Tribunal and Director Stroke Unit Wesley Hospital. He is also Chief Investigator for the Clinical Trial of more effective treatment for MS.

#### **Mr Kegan Scherf**

##### ***Workplace Relations Adviser, AMA Queensland***

Kegan is an industrial relations practitioner with extensive experience in the health and critical care environments. Kegan has both employer and employee representation experience and specialises in assisting medical practitioners and other registered health professionals on a wide range of employment matters such as unfair dismissal, public sector engagement, general protections, legislative compliance, workplace investigations, enterprise bargaining and workplace health and safety. Kegan thrives on working with medical practitioners to reach solutions on complex industrial matters. At present, Kegan is employed with the Australian Medical Association where he works with private practice doctors to ensure that their practice is able to respond to the challenges of our modern employment landscape. Kegan also represents the AMA's Visiting Medical Officer membership in enterprise bargaining with Queensland Health and Mater Misericordiae Hospitals.

#### **Dr Amanda Sillcock**

##### ***Occupational Physician***

Dr Amanda Sillcock is an occupational physician specialising in injury management, medico-legal assessments, toxicology advice/management, LMO liaison, fitness for duty assessments, health surveillance, return to work management, vaccination advice and occupational health and safety audits. Amanda is a well-regarded contributor to ANZSOM, having served at the Branch level and in her third year as Federal President.

#### **Dr Clair Sullivan**

##### ***Deputy Chair of Medicine, Princess Alexandra Hospital***

Dr Sullivan graduated with Honours in Medicine from the University of Queensland and has extensive clinical experience in endocrinology in Australia and the UK. She completed a Research Doctorate in Medicine (UK) at The General Infirmary at the University of Leeds. She maintains several national and international collaborations and research interests. She has received several large grants including a prestigious Pfizer CVL fellowship. Dr Sullivan is currently a senior staff specialist in Endocrinology and the Deputy Chair of Medicine at the Princess Alexandra Hospital. She is a co-Director of the Collaboration for Emergency Admission Research and Reform (CLEAR) which has received a large project grant from the Queensland Department of Health. She has an active interest in the metrics, management and improving the quality of hospital care, health informatics and analytics. Dr Sullivan continues to publish pioneering health systems research, presenting her work at national and international meetings and directly translating her work into improved patient outcomes.

#### **Mr Rob Timmings**

##### ***Rural and remote nurse educator, Director, ECT4Health***

Rob Timmings is a registered nurse with 27 years' experience in emergency, rural and primary care settings. For 14 years he has taught clinical skills including assessment, trauma and resuscitation. In 2004 he was endorsed as a Rural Isolated Practice nurse with immunisation being a significant aspect of his role while on remote placement. Previously employed as a nurse educator for Queensland Health, Rob was involved in the preparation of nurses for immunisation practice. Today he is the education director of a private nurse education organisation called ECT4Health. Still true to his origins, he works clinically in Emergency at Oakey, and also offering an immunisation service, around the various nursing CPD courses, seminars and conferences he is engaged for.



#### Dr Arlene Walker

*Psychologist, Associate Head of School (Rural and Regional Development), Deakin University*

Arlene is a registered psychologist with a Master's degree and a PhD in Industrial and Organisational Psychology. She is an Associate Head of School (Regional and Rural Development) in the School of Psychology at Deakin University and a Senior Lecturer in organisational psychology. Arlene is also the co-editor of the Australasian Journal of Organisational Psychology. From 2004 until March 2015 Arlene also provided part time employee support services for Barwon Health, dealing primarily with staff-related concerns and organisational development. Arlene has extensive research experience across a range of industries including: financial services, education, retail, utilities, heavy industry, defence services and the health industry. Her research interests include: the psychological contract; occupational health and safety; graduate work readiness and employee health and well-being.

#### Dr Chris Zappala

*Thoracic and Respiratory Physician, The Wesley Hospital*

Dr Chris Zappala achieved his MBBS at the University of Queensland and underwent his advanced training at the Royal Brisbane Hospital. Dr Zappala worked for two years in London at the Royal Brompton Hospital where he began his interest and research in interstitial lung disease and secondary pulmonary hypertension. His research interests include examining how change in serial pulmonary function and chest imaging describe disease behaviour and predict survival in interstitial lung disease. Dr Zappala is a Physician Partner at Genesis Care and consults in both public and private practice in Brisbane, Maroochydore and Hervey Bay.

invited speakers

## » sponsors, exhibitors & advertisers

### COMPANY PROFILES



#### Major sponsor – Sonic HealthPlus

Sonic HealthPlus is one of Australia's leading providers of occupational healthcare and general medical services. Their mission is to deliver best-practice healthcare solutions to customers by way of their national network of medical centres, site services and alliance clinics.

With over 50 years' experience, they understand the importance of protecting the health and wellbeing of your company's greatest asset – its workforce. It is for this reason they employ and work with some of the best and most experienced health professionals, including specialist occupational and environmental physicians, general practitioners, allied health professionals and medical support staff.

For more information about Sonic HealthPlus  
visit [www.sonichealthplus.com.au](http://www.sonichealthplus.com.au).



#### Dinner sponsor - beyondblue

beyondblue is an independent, not-for-profit organisation working to reduce the impact of depression, anxiety and suicide in Australia. They provide information and support to help people achieve their best possible mental health, wherever they live. They connect them with local health and community services, empowering people to recover and stay well.

beyondblue develops tools, resources and frameworks to create mentally healthy environments. Through their dedicated programs, they support schools, universities, workplaces and community organisations to protect and promote good mental health. Tackling stigma and discrimination across the Australian community remains a key focus for beyondblue. Their campaigns aim to break down the stigma that prevents people talking about mental health and seeking support, as well as encouraging everyone in Australia to respect gender, ethnicity, sexuality and cultural differences. Relationships with governments at all levels position them to advocate for change, as well as better outcomes for people experiencing mental health issues. Their research continues to shape the mental health sector, and they collaborate with partners across the field to advance our collective thinking, knowledge and approach.

For more information about beyondblue visit [www.beyondblue.org.au](http://www.beyondblue.org.au).



#### General sponsor - NSW Workers' Compensation Dust Diseases Board

The NSW Workers' Compensation Dust Diseases Board provide financial compensation and support to people who have had work-related exposure to harmful dust in NSW.

Along with compensation, we also fund on-going assistance to improve quality-of-life. This can include mobility aids, personal care, and medication and treatment from health professionals, as well as general assistance such as domestic support and respite care for families.

For more information about the NSW Workers' Compensation Dust Diseases Board  
visit [www.ddb.nsw.gov.au](http://www.ddb.nsw.gov.au).



#### Session sponsor - Austroads

Austroads is the association of Australasian road transport and traffic agencies. Austroads' purpose is to improve Australian and New Zealand transport outcomes by:

- » providing expert technical input to national road and transport policy development.
- » improving the practices and capability of road agencies.
- » promoting operational consistency by road agencies.

Austroads members are collectively responsible for the management of over 900,000 kilometres of roads valued at more than \$200 billion representing the single largest community asset in Australia and New Zealand. Each year in excess of \$18 billion is spent on roads across Australia and New Zealand.

For more information about Austroads visit [www.austroads.com.au](http://www.austroads.com.au).



#### Session sponsor - Slater and Gordon

Slater and Gordon is a leading international consumer law firm employing 1,400 people in 80 locations across Australia and 3,800 people across 27 locations in the United Kingdom. Slater and Gordon's mission is to give people easier access to world class legal services. Slater and Gordon provides specialist legal services to individuals in a range of practice areas including all areas of liability and compensation law, as well as other general legal services in areas such as family and relationship law, conveyancing, wills and estate planning. Their Business and Specialised Litigation Services includes commercial, estate and professional negligence litigation and class actions. Their firm is well known for its experience in running complex and large scale class actions.

For more information about Slater and Gordon visit [www.slatergordon.com.au](http://www.slatergordon.com.au).



#### bioCSL

bioCSL, a division of CSL Limited, is a leading provider of essential vaccines, pharmaceuticals and diagnostic reagents. They have served Australia's healthcare needs for almost a century and today they develop, manufacture and source medicines that support the health and wellbeing of many thousands of people around the world.

bioCSL operates Australia's only onshore manufacturing facility for seasonal and pandemic influenza vaccine and produces a range of unique medicines in the National Interest including antivenoms and Q fever vaccine. bioCSL also in-licenses a broad range of paediatric and adult vaccines and specialty pharmaceutical products. In Australia, bioCSL's established cold chain logistics business provides services both to Government and global health care product suppliers.

For more information about bioCSL visit [www.biocsl.com.au](http://www.biocsl.com.au).



#### eReports

Established in 2000, eReports is a national provider of a broad range of medico-legal services across a broad network of consulting locations. Their IMEs are amongst the most highly accomplished in their chosen fields, providing an exceptional service standard to a large range of clients in the corporate sector, legal profession, insurance industry, state and federal government departments. What is the eReports difference?

- » Complete financial transparency with secure 24/7 access to your banking and invoice records.
- » Full service support, we manage the entire service for consultants, your IME work is fully supported by eReports professional staff.
- » Control your schedule according to your preferences or lifestyle, we have a large network of consulting locations across Australia.
- » Travel and accommodation arrangements are managed by our in house travel team.
- » Their business model is unparalleled and empowers you to be placed amongst an industry leading team of Independent Medical Examiners across Australia.

For more information about eReports  
call 1300 130 963 or visit [www.eReports.com.au](http://www.eReports.com.au).

## EXHIBITORS AND ADVERTISERS



#### Amare Safety

Amare Safety commenced operations as a supplier of Personal Protective Equipment and associated products in the Australian market in 1985. It now stands in the marketplace as the leading privately owned safety house in Australia.

Amare Safety is continually refining and improving on our service offering as well as bringing to the market new products from the world's leading product manufacturers such as Prevor France, 3M.

Amare Safety strives to maintain the highest level of customer service in the industry and provide customers access to the widest choice of Personal Protective Safety Equipment on the market to achieve best practice.

For more information about Amare Safety  
call +61 385 420 400 or visit [www.amare.com.au](http://www.amare.com.au).

company profiles



## Falck

#### Falck

Falck has a long history of providing assistance and relief to people in distress. Based on their history and experience, they deliver medical services in various geographies. Their goal is to provide accessible, reliable, trustworthy patient-centred medical services. They do this in modern, well-equipped, centrally located medical centres and clinics, or by sending a doctor to the patient's home.

Falck operates medical services and clinics in over 44 countries across 6 continents. From clinical operations to doctors on call and 24 hr medical evacuation services, Falck is always there. Providing emergency medical services to the general public in 19 countries, in close collaboration with the authorities, Falck has more than 2300 ambulances, respond to four million emergency calls each year: to people who are critically ill, women in labour and accident victims. Falck also provides a large number of other pre-hospital services, including emergency helicopter and rapid response units with paramedics, nurses and doctors.

For more information about Falck visit [www.falck.com.au](http://www.falck.com.au).





#### MIGA

MIGA is a specialist insurer offering a range of medical indemnity insurance products and associated services to the healthcare sector across Australia. They have been supporting and protecting the medical profession for over 115 years and are committed to providing high quality, professional service and personal care to our clients and policy holders.

When you insure with MIGA you can be confident that:

- » You have broad insurance protection.
- » We will be there to support you both financially and emotionally, when a claim arises.
- » You have access to quality claims management services and risk management education.
- » You will receive the individual care and attention, for which we are renowned, and
- » We are continuously working to improve our service.

For more information about MIGA

call 1800 777 156 or visit [www.miga.com.au](http://www.miga.com.au).



#### mlcoa

MLCOA is a premier provider of Independent Medical assessment services to insurers, government departments, self-insured companies and the legal profession. With 25 years' experience, mlcoa delivers consistently high levels of reporting services by 300 respected and experienced Medical Specialists across all capital cities and key regional areas of Australia.

For more information see [www.mlcoa.com.au](http://www.mlcoa.com.au).



#### QML Pathology

QML Pathology has proudly supported Queensland for close to a century as a leading diagnostic pathology provider. With a dedicated commercial division, QML Pathology is integral in providing the highest standard of corporate medical testing for companies. Responsible for over 67,000 drug and alcohol screens per year, QML Pathology has built a reputation excelling in test accuracy, efficiency, reliability, and innovation. QML Pathology has 22 laboratories and over 635 collection centres across Queensland and northern New South Wales which are supported by a superior courier service that provides 24 to 48 hour turnaround on test results. With NATA/RCPA accreditation, their testing extends across:

- » Comprehensive drug and alcohol testing including as:4308 (urine testing) and AS:4760 (oral fluid testing)
- » Hazardous substance monitoring (heavy metals, herbicides, pesticides)
- » Pre & post employment screening
- » Immunisation/serology status
- » Personal health testing
- » Flu vaccinations
- » Expert consultative services

For more information about QML Pathology contact

+61 731 214 444 or visit [www.qml.com.au/commercial.aspx](http://www.qml.com.au/commercial.aspx).



**The Australian and New Zealand Society  
of Occupational Medicine Inc. (ANZSOM)**

# CERTIFICATE OF ATTENDANCE

~THIS IS TO CERTIFY THAT~

**ATTENDED THE ANZSOM  
ANNUAL SCIENTIFIC MEETING**  
23<sup>RD</sup> – 26<sup>TH</sup> AUGUST 2015 | BRISBANE, QUEENSLAND

  
**DR AMANDA SILLCOCK**

~FEDERAL PRESIDENT~

\*VALID ATTENDANCE ONLY IF ATTACHED TO A CONFERENCE TAX INVOICE IN THE DELEGATES NAME



## » delegates

Dr Mike Anderson  
Dr Anthony Arklay  
Dr Trish Batchelor  
Dr Craig Barnett  
Dr Priti Bhanot  
Mr Ryan Birch  
Dr Clem Bonney  
Dr Teresa Boyle  
Ms Cheryl Boysen  
A/Prof Anthony Brown  
Dr Nicholas Burke  
Dr Beata Byok  
Dr Philip Carrivick  
Mr Ian Cash  
Dr Pearlle M N Chan  
Dr Wing C. Chan  
Dr Poh Lin Cheah  
Mrs Sandra Code  
Dr David Crocker  
Dr John Cross  
Dr Louise Crowle  
Dr Chris Cunneen  
Ms Gwendoline Dempsey  
Mr Dean Dennis  
Dr Sandy De Silva  
Mrs Simone Durston  
Ms Robyn Dye  
Dr Garth Eaton  
Dr Andrew Ebringer  
Mrs Ruth Edwards  
Dr Graeme Edwards  
Ms Mary Finucane  
Dr Edward Foley  
Ms Jennifer Fraser  
Ms Jude French  
Dr John Gall  
Ms Annette Gentry  
Dr Maggie Goldie  
Dr Steven Goode  
Mrs Lea Graham  
Dr Geoffrey Graham  
Dr David Gras  
Dr Sophie Guerrini  
Mrs Lydia Gunston  
Dr Ian Hadwen  
Dr Steve Hambleton

Dr Andrew Harper  
Ms Wendy Hayes  
Dr Philip Haynes  
Dr Monica Hince  
Dr Bruce Hocking  
Dr Chris Homan  
Dr David Imlah  
Dr Flora Jethro  
Dr Miguel Sergio Kabilio  
Dr Jim Kafiris  
Mrs Sally Kane  
Judge William Kearns  
Mrs Elizabeth Keating  
Mr Patrick Kelly  
Ms Sylvia Kidziak  
Dr Devan Kumarasamy  
Dr Chea Kwok  
Dr Roger Lai  
Dr Leon Le Leu  
Dr Evelyn Lee  
Dr Virginia Li  
Ms Diane Lieutenant  
Dr John Low  
Dr William Ma  
Dr Michael MacMahon  
Dr Vern Madden  
Ms Cassie Madigan  
Dr Nigel Marsh  
Dr Tom Mastroianni  
Dr Sandra McBurnie  
Dr Robert McCartney  
Dr Therese McGrath  
Dr Gregory McGroder  
Sarah McInnes  
Dr Nigel Menogue  
Dr David Middleton  
Ms Melinda Miller  
Dr Andrew Milliken  
Dr Denis Mulkeen  
Dr Josh Munn  
Dr Celine Murphy  
Dr Choong Ng  
Dr Paul Niall  
Dr Ross Nolan  
Ms Juanita Nolan  
Mrs Hilary Oakley

Dr Christopher Oates  
Dr Walter CL Ong  
Dr Brett Oppermann  
Dr James O'Regan  
Dr Virginia Pascall  
Dr Nathan Pastor  
Dr Benson Pek  
Dr Paul Pers  
Ms Jillian Plummer  
Dr Ralph Poppenbeek  
Dr Karina Powers  
Dr James Provan  
Dr Jill Richardson  
Mrs Marion Ripolles  
Dr Mina Roberts  
Mr Martin Rogalski  
Dr Tania Rogers  
Dr Thomas Rosenthal  
Dr Peter Ruscoe  
Ms Karen Russell  
Dr Simon Ryder-Lewis  
Dr Katrina Sanders  
Dr Kalesh Seevarain  
Dr Amanda Sillcock  
Mrs Diane Silver  
Dr John Silver  
Dr John Sowby  
Dr Arthur Stratigopoulos  
Dr William Sutherland  
Mrs Karen Sweeting  
Dr Suzanne Teh  
Dr Jolita Theron  
Mrs Sally Tringham  
Dr Michael Troy  
Dr Andrew Van Ballegooyen  
Mrs Sylvia Van Camp  
Dr Margaret Vo  
Dr Lindesay Wagner  
Dr Joseph Waks  
Dr Peter Wilkins  
Dr John Wilson  
Dr George Wilson  
Mrs Linda Winn  
Dr Dominic Yong

# NEWCASTLE



We look forward to welcoming you to Newcastle for the 2016 Australian and New Zealand Society of Occupational Medicine Annual Scientific Meeting from 21st to 25th August 2016.



**NEWCASTLE**  
AUSTRALIA  
[visitnewcastle.com.au](http://visitnewcastle.com.au)

**newcastle**  
CONVENTION BUREAU

**The City of  
Newcastle**





The Australian and New Zealand Society of Occupational Medicine Inc. (ANZSOM)  
Suite 8, 150 Chestnut St, Cremorne VIC 3121

**P** 1300 666 515 | **F** +61 394 284 872 | **W** [www.anzsom.org.au](http://www.anzsom.org.au)